

# PROPOSED ROOF PLAN

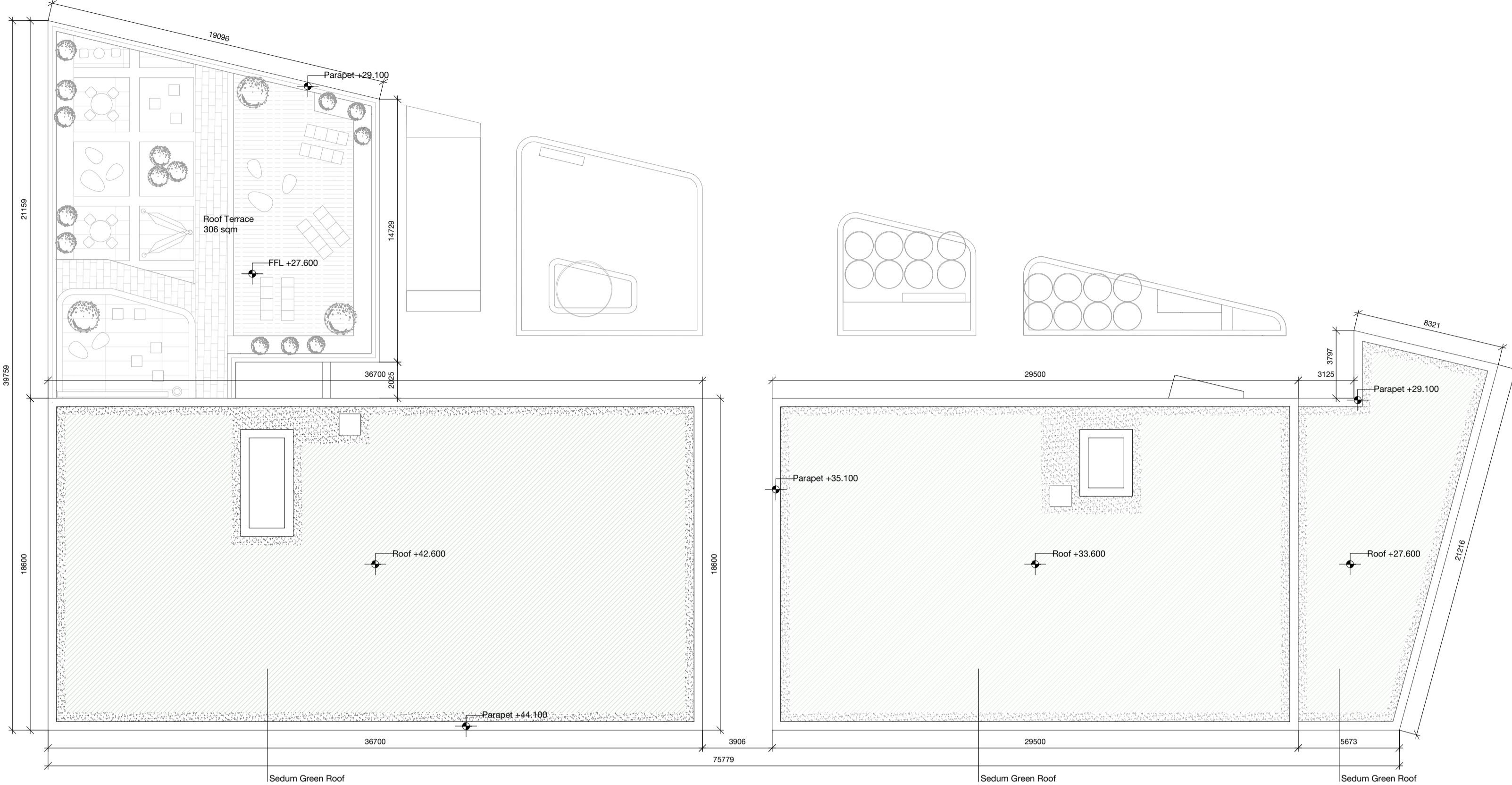

ROOF PLAN

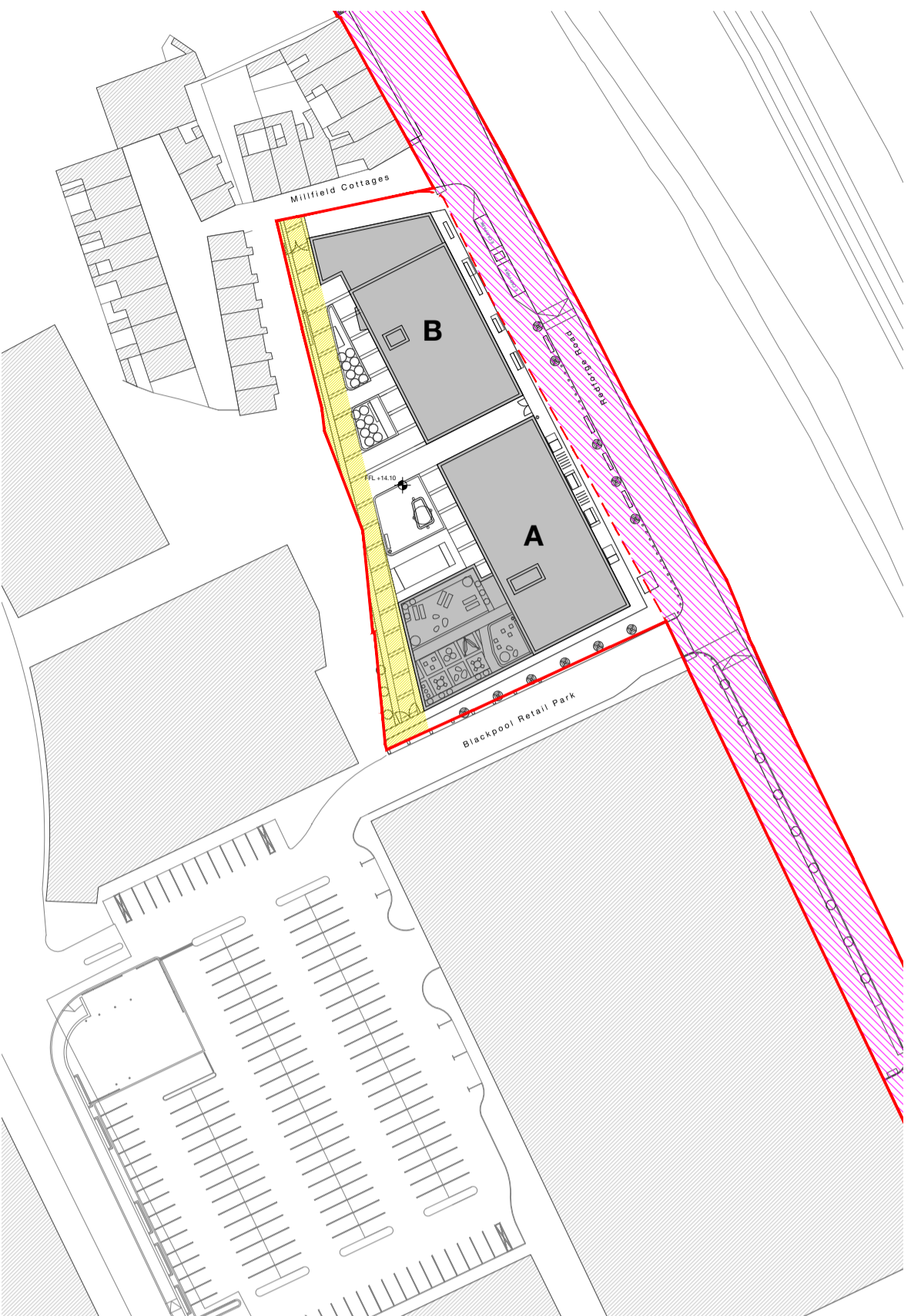

KEY PLAN 1:1000

- Proposed Development Site Boundary (Outlined Red) 7318m<sup>2</sup> / 0.73ha
- Land in Ownership of the Applicant 3372m<sup>2</sup> / 0.34ha
- Land Within Ownership of Cork City Council 3948m<sup>2</sup> / 0.39ha
- Area reserved for wayleave 453m<sup>2</sup>

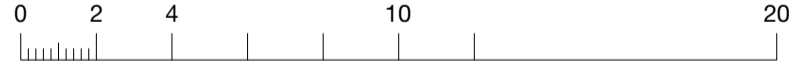
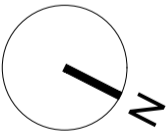

**Notes**



**Butler \ Cammoranesi architects**  
6 George's Quay, Cork  
T +353 21 2417273 \ E info@butlercammoranesi.ie  
butlercammoranesi.ie



**Project name** Redforge Road SHD Residential Development **Project no** 19082

**Client** Bellmount Developments Limited

<b>Drawing</b> Proposed Roof Plan	<b>Series</b> Planning	<b>Scale</b> 1:200@A1
-----------------------------------	------------------------	-----------------------

<b>Drawing no.</b> A10-06	<b>Revision</b> A	<b>Date</b> 2021/09/03
---------------------------	-------------------	------------------------